

BAT KT7 (USA/Canada) BAT KT8 (International) Chargers for Pocketalker 2.0

QUICK SETUP GUIDE

BAT KT7 (U.S.A. and Canada)



BAT KT8 (International)





Safety Warnings

1. To prevent injury, never charge the unit in enclosed spaces such as handbags, cases, or other closed storage bags.
2. To prevent injury, unplug this device during lightning storms, or when charging is complete and the device is unused for long periods of time.
3. To prevent injury, use correct AC adapter for country of use.
4. To prevent injury, use only the power supply provided by Williams AV. Other power supplies may have similar specifications, but may not be equivalent. Use of an unapproved power supply may leave the device partially or completely inoperable, and will void the warranty.
5. To prevent injury, protect the power cord from being walked on or pinched, particularly at plugs, receptacles, and near the power jack on the unit.

Product Description

The BAT KT7 and BAT KT8 are designed for charging the Williams AV Pocketalker 2.0 when used with NiMH batteries.

The BAT KT7 is the USA and Canada version with U.S. prongs.

The BAT KT8 is the International version supplied with prong adapters for the UK, Europe, and Australia. It is CE compliant and meets the requirements of Europe's Medical Device Directive.



WARNING!

USE THIS CHARGER WITH NiMH RECHARGEABLE BATTERIES ONLY - Williams AV P/N BAT 022 (or equivalent) AAA size NiMH, 1.2 VDC Rechargeable batteries).

Preparing the BAT KT7 charger for use

1. While holding the power supply, pry out the prongs with a finger.

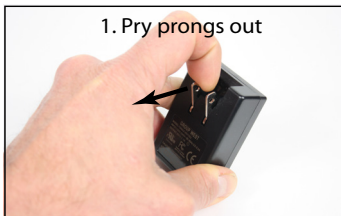

2. Continue pulling until the prongs stop.



Preparing the BAT KT8 charger for use

Choose the prong adapter for your country of use.

1. Place the prong adapter on the power supply as shown, sliding it down (right) as far as possible.



2. Pivot the adapter up/to the left until it clicks into place.



To **remove** the adapter:

1. Push down and pull back on the tab as shown.
2. With the tab pulled back, pivot the adapter to the right.

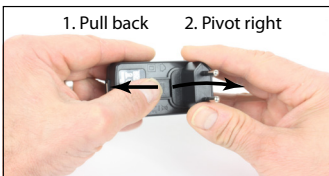

3. Once the adapter is free, release the tab.



Charging the Pocketalker

WARNING!

BEFORE CONNECTING THE CHARGER TO THE POCKETALKER, MAKE SURE THE POCKETALKER HAS NIMH RECHARGEABLE BATTERIES INSTALLED (NOT ALKALINE).

1. Open the Pocketalker battery compartment and set the battery switch to the NiMH position (Figure 1).

Figure 1: Battery Compartment

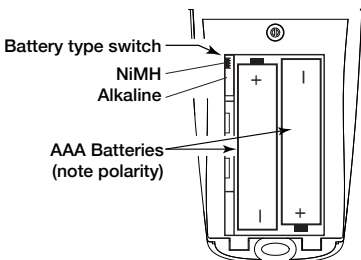

2. Insert two AAA NiMH batteries. Be sure to follow correct polarity (Figure 1).

3. Connect the USB Cable using Figures 2 or 3 depending on which charger is used:

a. Plug the USB "A" (larger rectangular) plug into the USB port of the power supply. Do not force it; if it doesn't slide in easily, it could be upside down. If it is, rotate it 180 degrees and try again.

b. Plug the USB "Micro-B" (smaller) connector into the charging port on the Pocketalker.

4. Follow the instructions in the previous section "Preparing the charger for use".

5. Plug the power supply into an AC wall outlet (Figure 2 or 3).

-The charging indicator on the Pocketalker will blink slowly while the batteries are being charged, then stay on when the batteries are fully charged.

-It will take approximately 16 hours to fully charge the batteries.

Figure 2: BAT KT7 Charging Connection

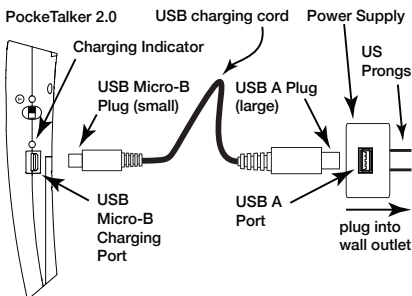
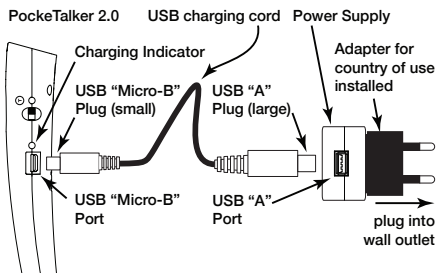

Figure 3: BAT KT8 Charging Connection



Power Supply Specifications

Weight	0.4 lbs
Input	100-240 VAC, 50-60 Hz, 0.5-0.3 A
Output	5 VDC, 2.0 A

Warranty

The BAT KT7 and BAT KT8 are covered by a 90 day warranty.

Customer Service

If you experience difficulty with your system, call Toll-Free for Customer Assistance:

1-800-328-6190 (U.S.A.) or

+1 952 943 2252 (Outside the U.S.A.)

If it is necessary to return the system for service, your Customer Service Representative will give you a Return Authorization Number (RA) and shipping instructions.

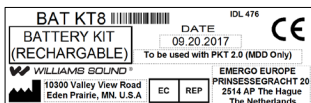

EU Authorized Representative:

Emergo Europe
Prinsessegracht 20
2514 AP The Hague
The Netherlands

WILLIAMS AV

info@williamsav.com / www.williamsav.com
800-843-3544 / INTL: +1-952-943-2252