

# **RINGER AMPLIFIER WITH STROBE LIGHT**

---

## **INSTALLATION**

1.  Connect the telephone line to telephone line jack. Connect telephone set to telephone jack.
2.  Install 3 AA batteries.
3.  Plug the AC adaptor cord to the power jack. Plug the AC adaptor to an AC outlet.  
 The AC adaptor output is 6V/1000MA.
4.  Adjust the volume of the ringer to your comfort level by sliding the ringer  
 High/Low/Off switch.
5.  Change ringer tone to high or low.

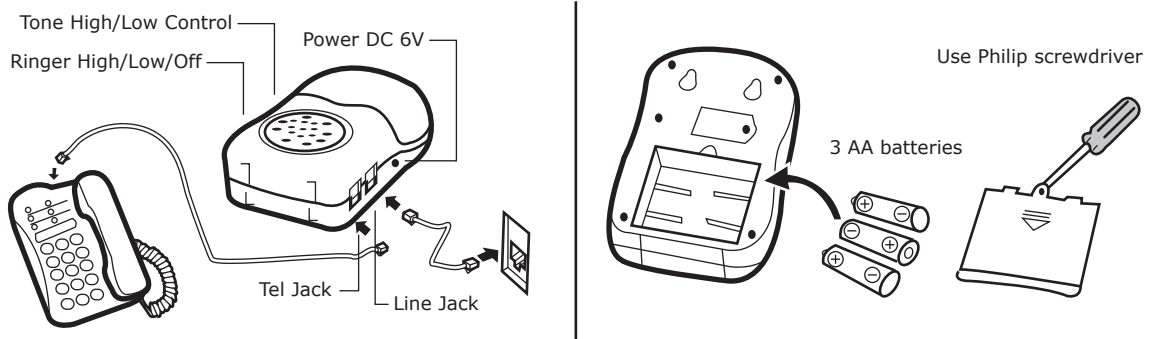

- WARNING:**
1.  Do not look directly at the strobe light when activated. It may harm your vision.
  2.  If no power is present, the ring function will work. The strobe light will not activate.