

HA360WRB - Quick Reference Guide

1 Setting Up Your HomeAware™

1. Remove all contents of the box.
 - HomeAware™ - Main Unit
 - HomeAware Security Alert
 - HomeAware Bes Shaker
 - NOAA Weather Radio
 - 3.5mm Connection Cable
2. Plug the power supply into back of the Main unit, 7.5V 2A DC IN.
3. Plug Main unit power supply into a 120V outlet.
4. Plug Vibrator / Bed Shaker into the vibrator outlet on the back of the Main unit. (Optional).

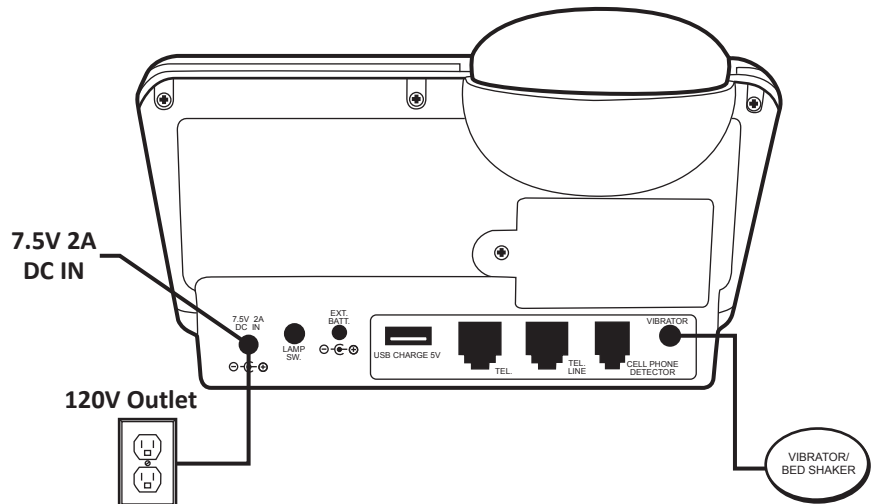

2 Setting Time of Day

1. Press the **Time Set** button. Blinking red dots will show on the display.
2. Press the **Hour** and **Minutes** buttons up or down to set desired time. When setting the time make sure the PM indicator light reflects the correct time.
3. Press the **Enter** button to complete.

For additional information refer to your HA360M2.1 User Guide.

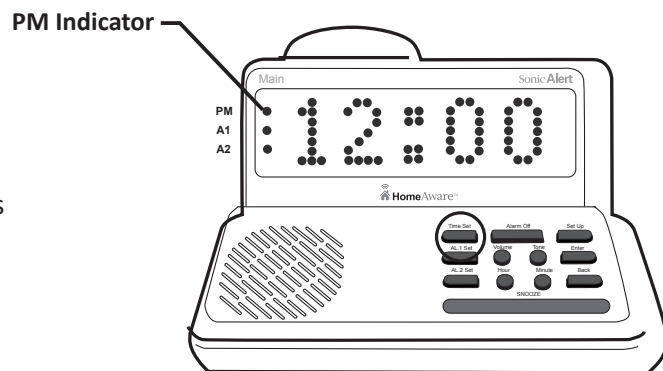

3 Connecting the HA360SA2.1 to your NOAA Weather Radio

1. Remove the 3.5mm Double-Ended Connection Cable
2. Plug the 3.5mm cable into the External Alert outlet on the back of your NOAA Weather Radio.
3. Plug the other end of your 3.5mm cable into the outlet on side of the HA360SA Security Alert.

For additional information refer to your HA360SA and NOAA Weather User Guides.

4 HA360SA2.1 Switch Locations and Positions

1. There are three switch positions on the back of the HA360SA
 - N / closed
 - N / open
 - Door chime
2. Using the HA360SA with the NOAA Weather Radio the switch should be in the N / open (Center location).

For additional information refer to your HA360SA2.1 and NOAA Weather User Guides.



HA360WRB - Quick Reference Guide

5 Installing the batteries into the HA360SA2.1 Security Alert

1. Install provided batteries into the bottom of the unit.
2. Once installed push the link button and the red LED light will light. If the light does not show, you may have the batteries in backwards.
3. Leave battery door opened to link the HA360SA to the Main unit.

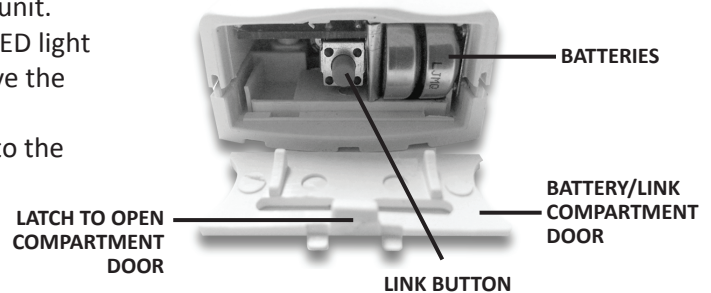

6 Linking the HA360SA2.1 to the Main Unit

1. Press **SET UP** button on the Main unit and the word **LINK** will be shown on the display, press **ENTER**. Link will be blinking.
2. Press and release the link button. **PICK DEVICE** will display on the screen, press the blue **TONE** button until **STORM** is displayed. Press the **Enter** button to complete.

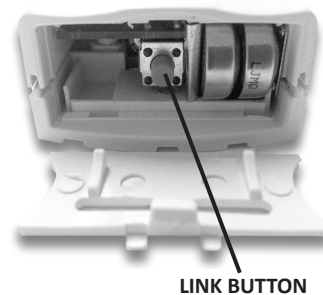

7 NOAA Weather Radio Quick Setup

1. Place 3 AA alkaline batteries (not supplied) into the compartment on the underside of radio.
(Note: Batteries provide approximately 5 hours of emergency power or 75 hours of standby power for the radio in case of a power outage).
2. Plug the AC Adapter into a standard outlet. Plug the other end of the adapter into the DC jack on the back of the radio.
3. Pull out antenna and extend to its full length.
4. Ensure ON/OFF switch is in the ON position
5. **WELCOME** will be displayed.
6. To **SET LANGUAGE** press the **SELECT** button then:
7. Choose your language by pressing ▲ or ▼ then press the **SELECT** button.
8. To **SET LOCATION** press the **SELECT** button then:
9. Choose location type **ANY** then press **SELECT**.
(Note: see page 8 for more programming instructions).
10. To **SET TIME** press the **SELECT** button then:
11. Set the time by using ► ▲ ▼ or then press **SELECT**.
12. To **SET CHANNEL** press the **SELECT** button then:
13. Tune the channel to the desired broadcast by using ▲ or ▼.
14. Adjust the volume by using the **VOLUME UP** or **VOLUME DOWN** button.
15. To complete setup press the **SELECT** button.

NOTE: To reset the radio to the factory defaults, press and hold the WEATHER / SNOOZE button while turning on the unit.